

Expert Level Course



# CHAOS<sup>®</sup> ENSCAPE FOR REVIT

## ENHANCE REVIT

Enscape™ is a real-time rendering and virtual reality plugin for Autodesk® Revit® (also for Rhino, SketchUp, Archicad, and Vectorworks). It plugs directly into your modeling software, giving you an integrated design and visualization workflow across all project phases. As a plugin to Revit, using Enscape as a real-time rendering tool won't disrupt your design workflow. Enscape allows you to explore your Revit project in a high-quality, real-time environment. This is especially useful for client presentations and design processes.

## Course Overview

The purpose of this training programme is to enable users who have worked with Revit to expand their knowledge in the real-time rendering software application such as Enscape. The trainee's will be shown the principal of the Enscape tools and testing their knowledge by completing training exercises.

## Recommended experience level

The user should be comfortable with the fundamentals of the Revit software, as taught in the various ArcDox Revit Essential training programmes. Knowledge of basic techniques is assumed, such creating walls, roofs, and other objects; copying and moving objects; creating and working with views etc.

## Modality

3 Day course (1hr/day) delivered online using Microsoft Teams.

## Material

Training Handbook and Revit files are provided by Arcdcox.

## Certificate

In addition as Autodesk® Authorized Training Centre (ATC®) you will receive an official certificate from Autodesk at the end of the course. This course was designed to meet your learning needs with professional instructors, relevant content, authorized courseware, and evaluation by Autodesk.

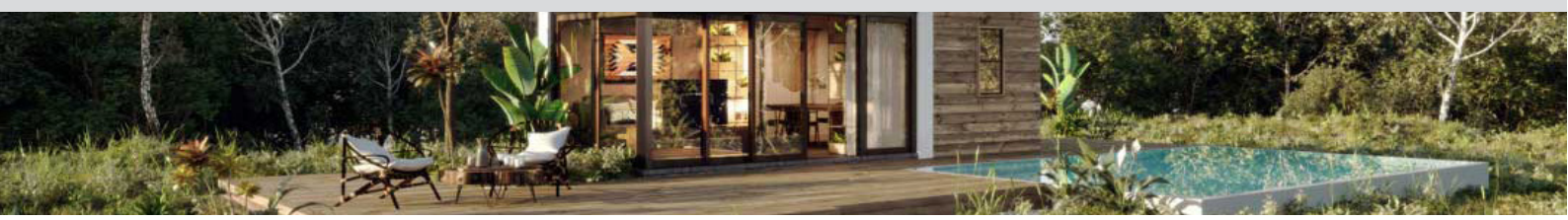

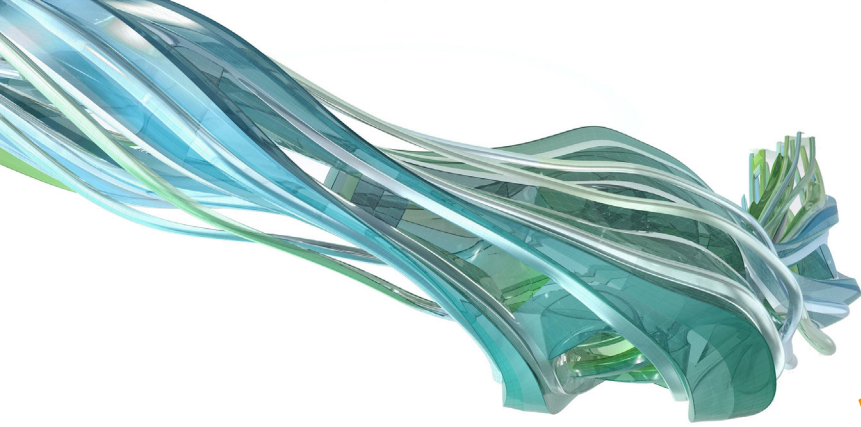

## ENSCAPE FOR REVIT Modules

### About Training in ArcDox

ArcDox is unique in Ireland as the only working practice that is also an AutoDesk Authorised Training Centre. Our AutoDesk Certified Trainers, are also professionally qualified users, working with BIM on a daily basis.

We can provide a range of online training options, whether at our scheduled courses (check our website for pricing and dates), or On-Site training at your company or for your project teams. We are also developing bespoke Training courses which are underpinned by ArcDox's expertise and support services, compiling all modules that might be relevant for your role or team, give us a call and let our experts prepare a full plan for you.



### ARCDX

Architecture & Training Centre

8 Fem Road  
Sandyford Business Park  
Dublin D18 FP98  
Ireland.

mail@arcdox.com

Tel: +353 (0)1 4371200

#### Day 1 – Overview of Enscape

- Getting familiar with the new Enscape interface
- Navigating around an existing Revit model
- Creating views either from Revit and Enscape environment

#### Day 2 – Rendering with Enscape

- Applying material in Enscape
- Using a Enscape material library and editor,
- Applying video texture on Revit surfaces,
- Applying Enscape objects using the Asset Enscape library for a single or multi placement
- Modifying Enscape setting for animated assets

#### Day 3 – Video recording and Collaboration within Enscape

- Rendering an image either into Revit, or exporting it in your computer
- Creating and saving panoramas locally, on the cloud
- Sharing panorama through QR code
- Recording a video
- Placing a sound source
- Overview of the collaborative annotation tool to exchanging and tracking comments.